

Deconta C5000E Decontamination Trailer

The Deconta C5000E Decontamination Trailer complete with Electric Water Heating.

PLEASE NOTE A 230V POWER SUPPLY IS NECESSARY FOR THE OPERATION

- Frame construction aluminium
- wall material with double-sided coating
- chassis design steel galvanized
- Tandem-chassis rubber mounted
- overrun brake and hand brake
- 2 extractable stairs
- Electric-water heating via 3 kW heating element, Power supply of 230 Volt necessary for the operation.
- Central operation via smart touch Display, LED-lighting with motion detector, coat hooks, 230 V power plug, mirror, lockable storage compartments, lockable
- external door, anti-slip aluminium-flooring
- Negative pressure unit
- Spare wheel incl. holder, lifting jack, nut spanner
- External door self-closing

A 3.2KVA generator or mains power supply is required for all operations. GENERATOR NOT SUPPLIED BY ASSURED EQUIPMENT SERVICES.

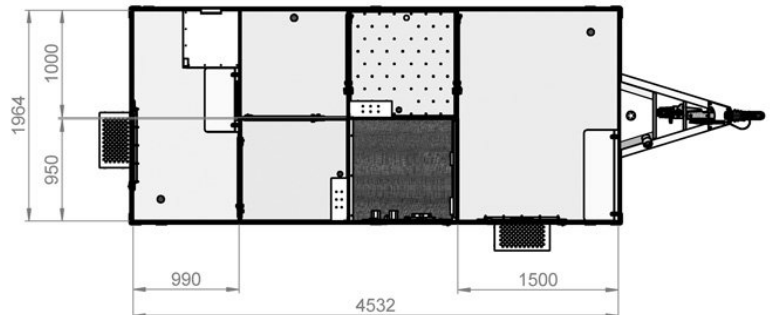

Recommended Spares



- 25 Micron Sediment Filters \$10.95inc each – Requires 2 per trailer

- 5 Micron Sediment Filters \$10.95inc each – Requires 2 per trailer



- Pleat Filter for Negative Pressure Unit \$12.10inc each – Requires 1 Per trailer